

# MONITORING MERSEN DUSTCOLLECTOR

## MAKING THE MOST OF MERSEN DUSTCOLLECTOR



Smart M3

### MONITOR THE PERFORMANCE OF MERSEN DUSTCOLLECTOR

= Input / Output interfaces  
for interaction between machine and operator

**Thresholds** can be set to trigger alarms.

**Information** is transmitted by dry contact (max 6A / 230VUC) and/or Ethernet network depending on the option you choose.

The **electrical cabinet** can be installed on the vacuum unit or close to the generator.



For your peace of mind, Mersen's specialists can take care of the mounting operations!

MERSEN PROPERTY



**WE OFFER 3 LEVELS OF  
MONITORING SYSTEMS TO  
MEET YOUR REQUIREMENTS \***

#### BASIC M1

- ✓ Filtration state (filter clogging)
- ✓ Vacuum fault
- ✓ Components fitted into an electrical cabinet

#### OPTIMUM M2

= "BASIC M1",  
PLUS OTHER OPTIONS:

- ✓ Brush wear
- ✓ Stop & Go operation (Eco mode)
- ✓ Others, please inquire

#### SMART M3

= "OPTIMUM M2",  
PLUS OTHER OPTIONS:

- ✓ Slip ring compartment temperature
- ✓ Visual alarm
- ✓ Touch screen display
- ✓ Possibility of Ethernet connection (remote display)
- ✓ Operation statistics, alarm history
- ✓ Others, please inquire

\* Above features are only samples of the possibilities of our monitoring systems.

Please inquire for more info:  
[info.ptt@mersen.com](mailto:info.ptt@mersen.com)

**BASIC**

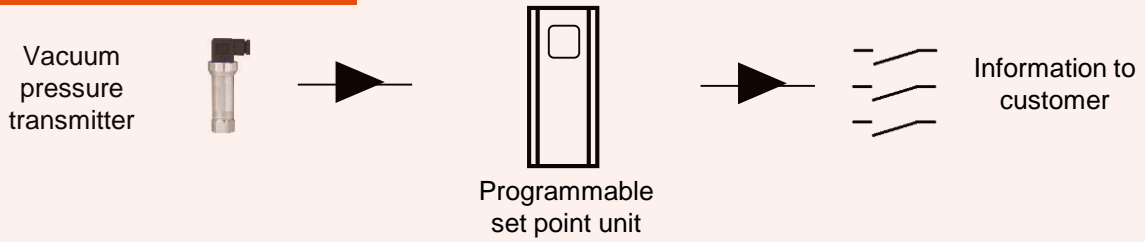

**OPTIMUM**

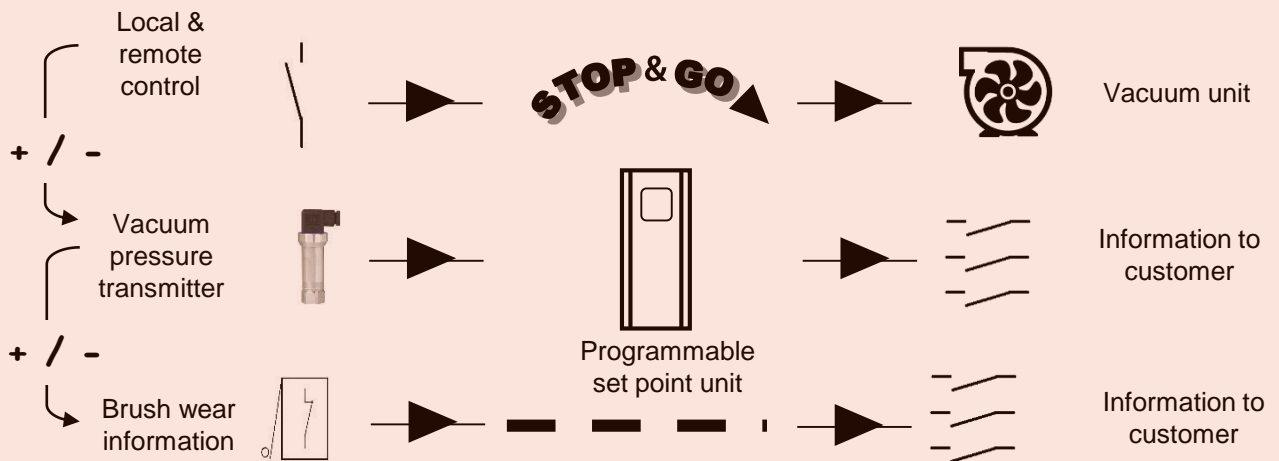

**SMART**

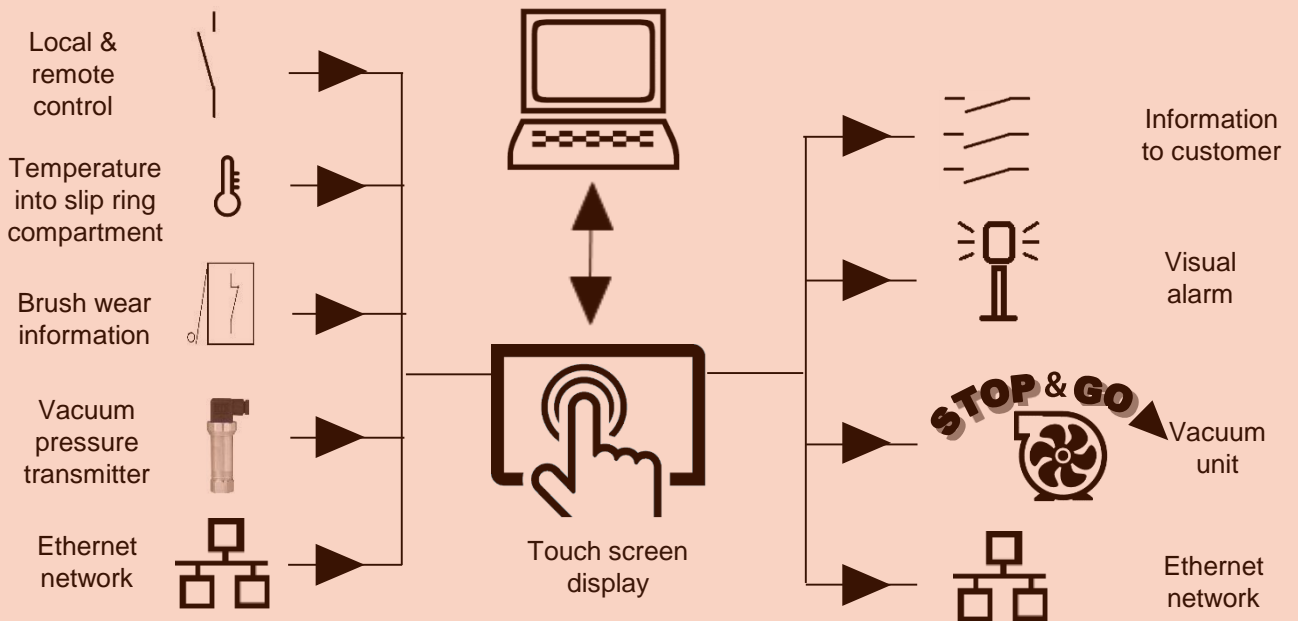

PTT-MDC-monitoring-EN-2001

MERSEN PROPERTY

Contact: [info.ptt@mersen.com](mailto:info.ptt@mersen.com)